

Amarillo Series Fan Drive

Model 1110

Amarillo Gear Company LLC reserves the right to make design modifications to our gear drives that may change the given dimensions. The dimensions shown in this document may not exactly reflect the dimensions of gear drives currently being offered. Request a *certified dimension print* for construction use.

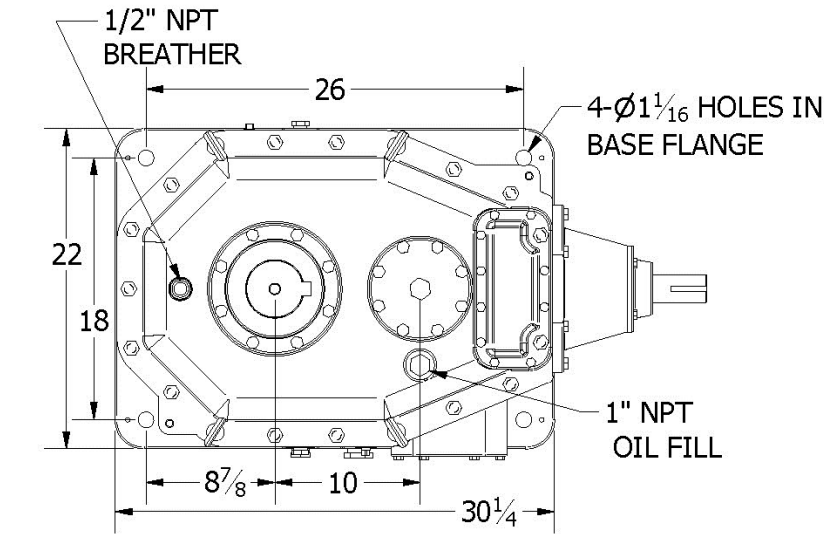

OIL PUMP (OPTIONAL) MINIMUM CLEARANCE

LOCATED BENEATH THE INTERMEDIATE SHAFT.
CONTACT THE FACTORY FOR ADDITIONAL
INFORMATION AND A CERTIFIED DIMENSION PRINT.

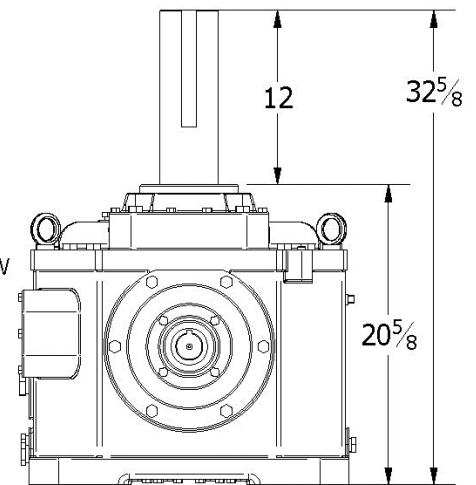
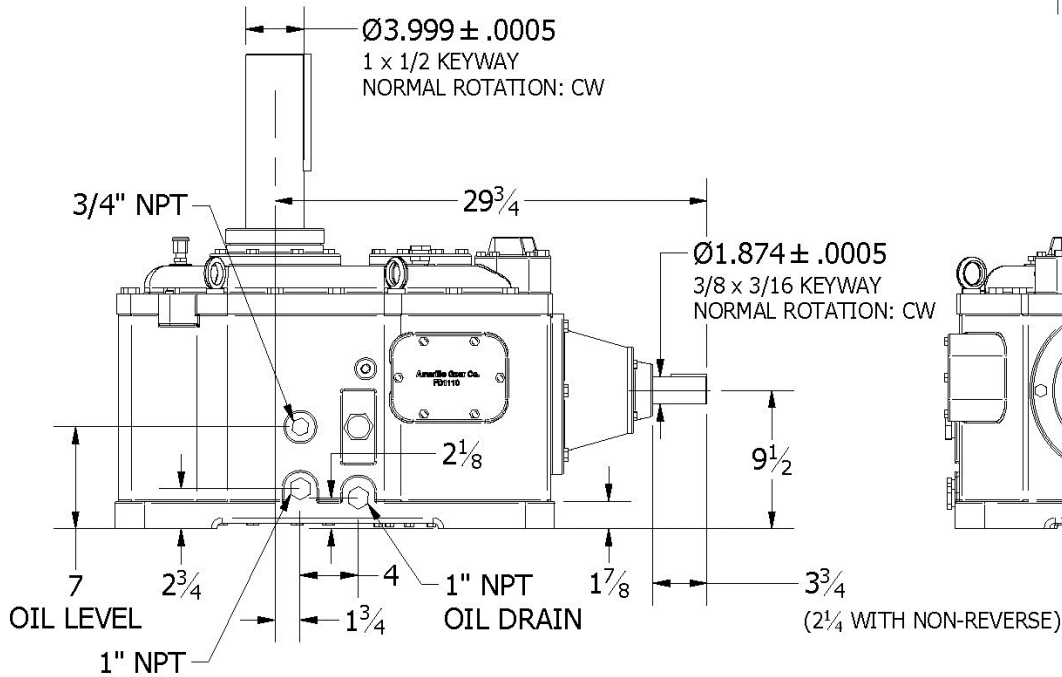
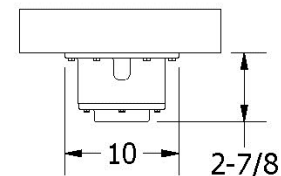

SERVICE HORSEPOWER RATINGS

(2.0 SERVICE FACTOR)

Input (RPM)	Nominal Ratio										
	7.5	8	8.5	9	9.5	10	10.5	11	12	13	14
1750	142	142	141	140	135	130	130	130	125	125	120
1450	118	118	117	116	112	108	108	108	104	104	99
1160	94	94	93	93	89	86	86	86	83	83	80

THRUST CAPACITY: _____ 5400 lbs.
 OIL TYPE: _____ ISO 220 / AGMA 5 or 5S / No EP additives
 OIL CAPACITY: _____ 8.5 gallons (32 L)
 WEIGHT, DOMESTIC SHIPPING: _____ 1375 lbs.
 WEIGHT, EXPORT SHIPPING w/EXPORT BOX: _____ 1485 lbs.
 EXPORT BOX DIMENSIONS (L x W x H): _____ 48 x 28 x 41 (inches)